

CTIC Mini Terminals

Protectowire Linear Heat Installation Accessories

Description

The CTIC Mini splicing terminals are used when splicing CTI detectors. Includes male and female connectors.

Material: Glass filled thermoplastic

Temperature Rating: 428°F (220°C) continuous

Correct polarity must be maintained

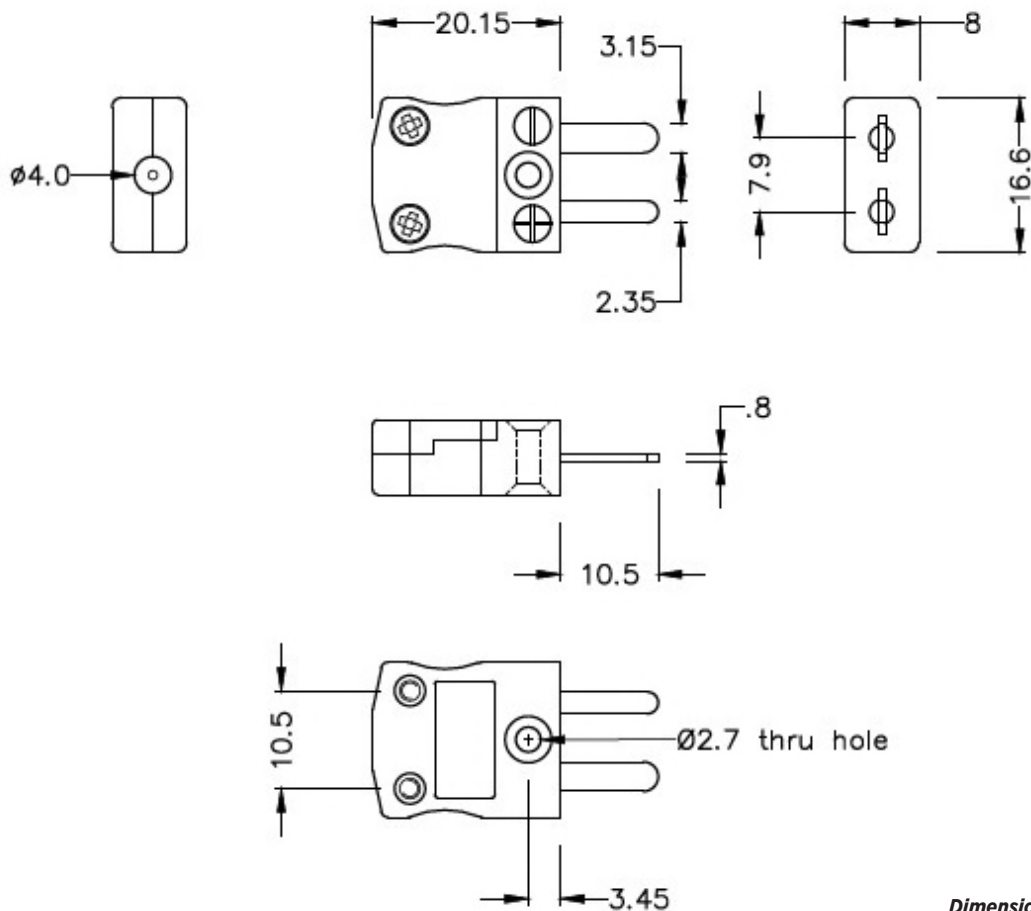

Dimensions in mm